



北京舞蹈学院

BEIJING DANCE ACADEMY

北京舞蹈学院  
留学生/港澳台生 **生活指南**



## **I** About BDA

- 1. Introduction / 01**
- 2. Departments / 03**

## **II** Enrollment

- 1. From airport or railway station to school / 06**
- 2. Process of enrollment / 07**
- 3. Apply for a bank card / 07**

## **III** Campus life

- 1. Food / 09**
- 2. Accommodation / 09**
- 3. Shower / 09**

## IV Study in Campus

1. Library / 10

## V Daily Tips

1. Daily essentials / 12
2. Practical app / 13

## VI Appendix

1. Campus map / 14
2. Beijing subway map / 15





# I

## About BDA

### 1. Introduction

Beijing Dance Academy was established in 1954, formerly known as “Beijing Dance School” which was for secondary dance professional education. It was promoted to an institution for college education through the transformation in 1978; then obtained the degree granting rights for dance master in 1999 and for master of fine arts (MFA) in 2005, followed by a joint program for Ph.D. students initiated in 2010 in cooperation with Peking University. Being an exclusive specialized dance institution of higher education in China, as well as a famous dance academy with the largest scale and overall specialty setting worldwide, the academy offers programs at secondary, undergraduate and postgraduate levels.

Known as “the cradle of dancers”, neighboring the picturesque Zizhu Park, the academy ushers in and sees off numerous students to chase and realize their dancing dreams, which is indeed “students with talents blossoming and harvesting”. At present, the academy has nearly 600 permanent faculty members, about 2,500 full-time students, total 5,303 students of the School of Continuing Education



including 698 degree students and 4,605 non-degree students, more than 30,000 teachers of the School of Dance Grade Examination and Education doing dance grade training at home and abroad every year, and nearly 300,000 students attending dance grading tests.

Beijing Dance Academy comprises educational institutions including the Department of Chinese Classical Dance, the Department of Chinese Ethnic and Folk Dance, the Ballet Department, the Department of Social Dance, the Department of Musical Theatre, the School of Creative (consisting of the Choreography Department, the Department of Art Design and the Education and Research Center for Modern Dance), the Department of Liberal Arts (consisting of the Department of Dance Studies, the Department of Art Communication, the Department of Fundamentals Course and the Teaching and Research Department for Ideological and Political Theory), the School of Education, the Graduate Faculty, the BDA Youth Dance Company, the School of Continuing Education, the School of Dance Grading Examination and Education, and the Affiliated Secondary School of Beijing Dance Academy. A unique system of dance education with Chinese characteristics has been established concerning academic subjects such as dance performance, dance education, choreography, dance history and theory, art design, art management, new media, and somatic science of dance.

For 60 years since it was founded, the academy has earnestly implemented the party's guidelines for education and arts, and operated the working thought of "holding the banner, leading the culture, administration by law and harmonious development". Based on Chinese traditional culture, it has assimilated worldwide splendid culture. Led by the school motto as "Morality and Harmony, Nature and Human, Culture and Dance, Virtue and Art", the academy endeavors to promote and develop its tradition of "patriotism and love for school and dance". It has striven to achieve the goal of "insisting high level cultural pursue, high quality talents cultivation and high-level popularization of education", and made continuous efforts to the renaissance of Chinese culture, development of dance business, and build up world-class dance higher education, continuing the splendid history.

Add: No. 1 Wanshou Road, South Main Street, Zhongguancun

Tel: 010-68937373



## 2. Departments



- **The Department of Chinese Classical Dance**

Add: 5/F, Office Building

Tel: (010) 68935734

E-mail: gdwx@163.com



- **The Department of Chinese Ethnic and Folk Dance**

Add: 5/F, Office Building

Tel: (010) 68935735

E-mail: mjw2012@sina.cn



- **The Ballet Department**

Add: 6/F, Dance Teaching Building

Tel: (010) 68935736, 68935737

E-mail: daballet@163.com

Official Weibo: 北舞芭蕾舞系

Wechat: BDAballet



- **The Department of Ballroom Dance**

Add: 6/F, Office Building

Tel: (010) 68935762



### ● The Department of Musical Theatre

Add: 6/F, Office Building

Tel: (010) 68935658

E-mail: musical2014@163.com



### ● Creative School

1. The Choreography Department

Add: 2/F, Shalong Stage

Tel: (010)68937370

E-mail: bdx7370@sina.com

2. The Education and Research Center

for Modern Dance

Tel: (010) 68935772, 68935741

Fax: (010) 68936694

E-mail: moderndancecenter@hotmail.com

3. The Department of Art Design

4. Office location: The Department of Art Design,

4/F, Shalong Stage, Beijing Dance Academy

Tel:(010)68935703

Fax:(010)68931959

E-mail: art\_design2002@sina.com



### ● The Department of Liberal Arts

1. The Department of Dance Studies

Add: E201, Office Building Tel: (010)68935808 E-mail: wudaoux@126.com

2. The Department of Art Communication (010)68935984

3. The Department of Fundamentals Course

Add: 2/F, Office Building Tel: (010)68935733 E-mail: wyggjcb@126.com

4. The Teaching and Research Department for Ideological and

Political Theory (010)68935733

● **The School of Education**

Add: 4/F, Office Building

Tel: (010)68936029

● **The Graduate Faculty**

Add: 2/F, Office Building

Tel: (010)68935728



● **The School of Continuing Education**

Tel: (010) 68935941, Fax: (010) 68937118

Teaching Affairs Department: (010) 68936106, 68936007  
(correspondence course)

Public Relations Department: (010) 68936002, 68936006

Admissions Office: (010) 68935861

(correspondence course), (010) 68935931 (training),  
(010) 68936006 (Confucius Institute, publicity)

Finance Office: (010) 68935824

Add: 2/F, Shalong Stage, Beijing Dance Academy

E-mail: bdajxjxy@163.com

● **The School of Dance Grading  
Examination and Education**

(010)68936120

● **The Affiliated Secondary School of Beijing  
Dance Academy (010)68935775**

Office Location: Building of the

Affiliated Secondary School



● **The BDA Youth Dance Company**

Add: Youth Dance Company, 1/F, Shalong Stage

Tel: (010) 68935790 Fax: (010) 68938068



## II Enrollment

### 1. From airport or railway station to school



#### ● Capital Airport to Beijing Dance Academy

Take airport bus (Gongzhufen line) to urban area (get off at Friendship Hotel Station), which costs about 24 yuan (RMB, the same below); transfer to bus No.695/No.658/No.332/No.717/Special No.4/No.26 etc., which costs about 2 yuan, get off at Minzu University of China Station



#### ● Beijing West Railway Station to Beijing Dance Academy

Take Line 9, get off at Exit A2 of National Library, which costs about 3 yuan. Turn left at the entrance of Shenzhou Hotel Road and walk 400 meters to the south gate of Beijing Dance Academy



#### ● Beijing South Railway Station to Beijing Dance Academy

Take Line 4, get off at Exit A2 of National Library, which costs about 3 yuan. Turn left at the entrance of Shenzhou Hotel Road and walk 400 meters to the south gate of Beijing Dance Academy

## 2. Process of enrollment

Pay in Finance Office → Enroll in International Office (Hong Kong Macao and Taiwan Office) with the fee receipt and admission letter → Enroll in Teaching Affairs Department → Clinic (see the letter of admission).

## 3. Apply for a bank card

International students need to apply for a debit card of Bank of Beijing for opening the campus smart card. The amount transferred from this bank card can be used for demands of daily life like having meals in school, taking a shower (unneeded in International Students' Building) and surfing the Internet etc.

Address of sub-branches of Bank of Beijing which are the nearest to school:

### ● Weigongcun Sub-branch of Bank of Beijing

Add: 1/F, Zhongyang Mansion, No.27 South Main Street, Zhongguancun, Haidian District, Beijing City

Tel: (010) 68937792

Exit from the north gate of school, turn right and walk 400 meters to the bank (marked with red spot in the map)

### ● Baishiqiao Sub-branch of Bank of Beijing

Add: Youth Dance Company, 1/F, Shalong Stage, Beijing Dance Academy, No.1 Wanshousi Road, Haidian District, Beijing City

Tel: 010-68935790 (Fax: 010-68938068)

Exit from the south gate of school, turn left and walk 400 meters, then turn right and walk 100 meters and cross the road to the bank (marked with red spot in the map)





Weigongcun Sub-branch of Bank of Beijing



Baishiqiao Sub-branch of Bank of Beijing



### III

## Campus life

### 1. Food

Canteen one: 103-105, 1/F, Main Building

Canteen two: 2/F of West Gate Canteen (1/F is for staff canteen and Muslims' canteen)

Supermarket one: 1/F, Department Office Building (the northeast corner of main building)

Supermarket two: Next to the West Gate Canteen

Fruit store: 105, 1/F, Main Building (next to canteen one)

### 2. Accommodation

Generally, international students will be arranged to live in the international students' building.

Price standard for accommodation of international students' building

Less than (including) 30 days, standard double room, 90 yuan for per person per day

31-90 days (including), standard double room, 75 yuan for per person per day

More than (including) 91 days, standard double room, 60 yuan for per person per day

### 3. Shower

A bathroom is provided in each room of the international students' apartment for daily washing and shower. Besides, there is a public bath house in school, located in F-1—F-2, No.2 Family Dormitory Building, West Gate of school.

Note: You need to use the campus smart card for most of activities involved in food, accommodation and transportation in school. If your card is lost, please go to the campus smart card center (1/F, Department Office Building) for reporting the loss in time.

## IV Study in Campus

### 1. Library

Library of Beijing Dance Academy was built in 1991. Through construction and development for nearly 20 years, now it has developed into a library of municipal key art university with a considerable scale and close combination of comprehensiveness and professionalism. The library covers a current net area of 2240m<sup>2</sup>, provided with 1 double layered stacks, 1 single layered open-shelf stacks, 3 reading rooms, 2 computer multi-media classrooms and 1 multifunction room. The collection of our library is aimed at thoroughly collecting dance books and related audiovisual material at all times and building up a resource database with dance characteristics. The library has a total collection of more than 200,000 volumes of Chinese and foreign books, journals, tapes, discs, photos and materials in sheets, including professional materials of dance which cover more than 50% of the total. It is the professional materials of dance with the longest collection history, the greatest variety and the highest value nationwide.

The Circulation Department of library including circulation desk, dance reference room, reading room for reference book and journals and reading room for arts open to teachers and students of the whole school. Its major service items are as follows: providing collection and lending of books for teachers and students; retrieving and searching for document resources; professional reference and consultation; copying, printing, scanning and binding documents etc. It is a service department with functions of collection, searching, circulation, reading and consultation.

Contact Tel: (010) 68935742.



● **Operational hours and service items of all rooms of library**

Name of Office	Location	Open Hour	Services
Circulation Desk	4 <sup>th</sup> floor, Library Building	Mon-Fri: 8:00-17:00	Borrowing and returning books; printing, photocopying, scanning
Self-service	1 <sup>st</sup> floor, Library Building	7/24	Returning books
Dance Reference Room	4 <sup>th</sup> floor, Library Building	Mon-Fri: 8:00-11:30 14:00-17:00 18:30-21:30	Reading dance books; scanning to USB; studying
Periodical Room	4 <sup>th</sup> floor, Library Building	Sat: 14:00-17:00 18:30-21:30	Reading periodicals; studying
Reference Book Room	5 <sup>th</sup> floor, Library Building	As demanded	Reading reference books
Studying Room	5 <sup>th</sup> floor, Library Building	Mon-Fri: 8:00-21:30 Sat: 14:00-21:30 Sun: 14:00-17:00	studying

Note: Circulation Desk and Dance Reference Room are not open on Wednesday

● **Library map**

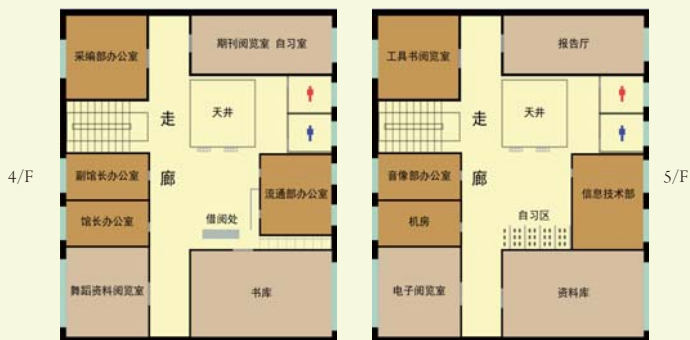

Note: The library has been integrated with the campus smart card system. Readers can borrow books in the library with the campus smart card.

# V

## Daily Tips

### 1. Daily essentials

#### ● SIM card

At the beginning of every academic year, related staff of China Mobile, Unicom and Telecom will be sent to school for holding some sales promotions in exercise equipment active area in west gate of school or Shishengyuan. Current students can participate in “campus special offers” of the current year as a student, which will be more preferential than applying for a card yourself! Remember to bring your identity card and campus smart card with you.

#### ● Beijing Municipal Administration & Communication Card

Essential for taking bus and subway. You can buy one in any subway station with 20 yuan for guarantee deposit, then you can recharge it and use the amount in it. The nearest purchasing spot is the National Library Station!



## 2. Practical app

### ● Social chat No.1 wechat; QQ; Weibo



微信



QQ



微博

### ● Essential for going out Baidu Map; Amap; 12306 China Raidway



百度地图

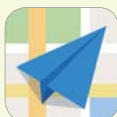

高德地图



铁路 12306

### ● Reading TOP 3



Anyview 阅读



咪咕阅读



百度阅读

### ● Essential for foodies



饿了么



美团外卖



百度外卖

### ● Photo taking TOP 3



美图秀秀



美颜相机



Faceu



# VI Appendix

## 1. Campus map

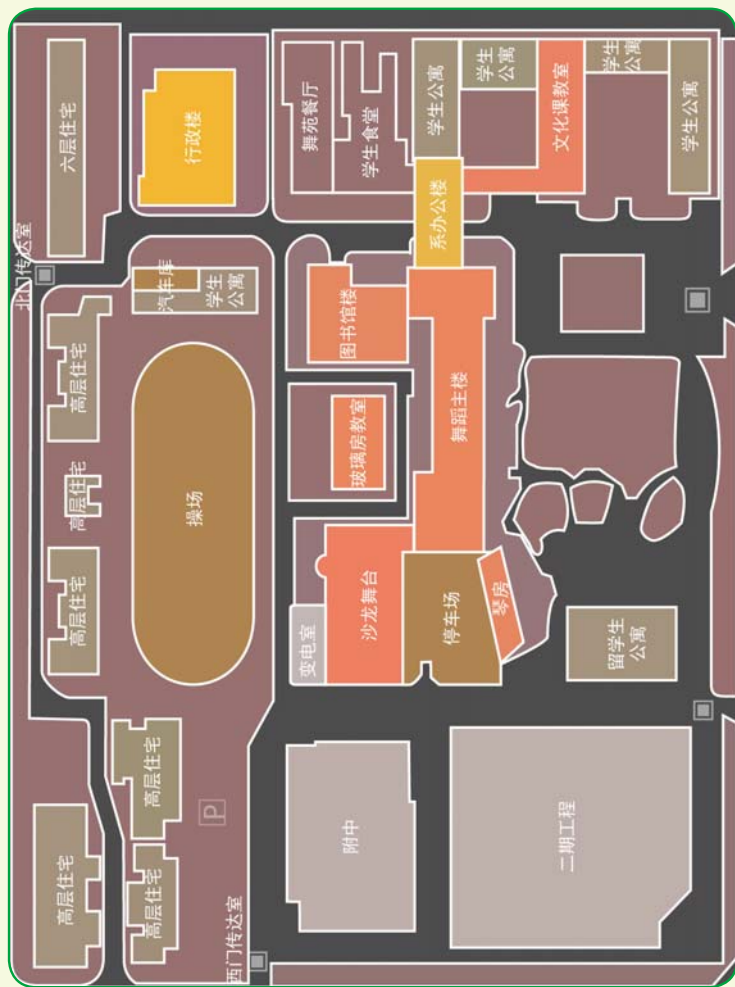



## 2. Beijing subway map

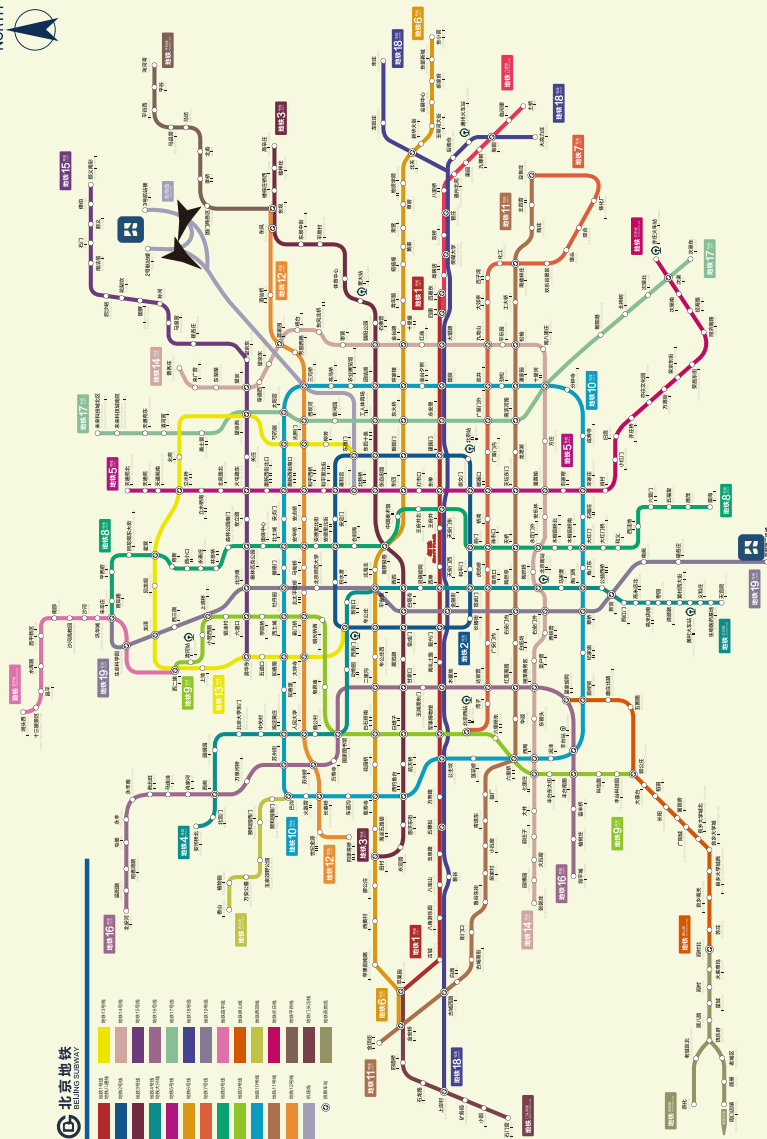



Welcome  
to Beijing Dance  
Academy. If you encounter any  
problem or have any suggestion  
at school, feel free to contact us  
in following way at once.

International Office  
(Hong Kong Macao and Taiwan Office)  
Beijing Dance Academy  
Address: 1/F, International Students' Apartment  
Office Hours: Monday to Friday 8:00-11:30, 14:00-17:00  
Contact Tel: (010) 68937373



北京舞蹈学院

BEIJING DANCE ACADEMY

## Enrollment Guidelines for International Students of Beijing Dance Academy

